

WZ45N Integrated Day/Night IR Dome

www.boschsecurity.com



BOSCH
Invented for life



The WZ45N Integrated Day/Night Dome camera is a vandal-resistant, user-friendly surface mount camera designed for effective 24/7 surveillance. Equipped with a 520 TVL mechanical filter CCD and 18 high-efficiency LEDs, the WZ45N delivers vivid daytime color and 18 m (60 ft) of active-infrared night vision. All-weather ready and rich with practical enhancements, the WZ45N is ideal for a wide variety of security applications including schools, commercial property and correctional facilities.

Functions

Evenly-distributed night vision

- 18 m (60 ft) exceptional night vision
- 30 m (100 ft) infrared range
- Even distribution IR for optimal image capture

Mechanical Filter for outstanding 24/7 performance

- Enables exceptional image capture in day and night conditions
- Sensitive to visible light in day conditions, producing vivid daytime color
- Switches to infrared in night time conditions for irrefutable image capture
- Photocell controlled for maximum energy efficiency

- ▶ Robust vandal-resistant construction
- ▶ User-friendly design and OSD for easily-adjustable camera settings
- ▶ 520 TVL 1/3 in CCD with Mechanical Filter Technology
- ▶ 18 m (60 ft) of exceptional night vision performance
- ▶ All-environment IP66 housing, conduit compatible

User-friendly design

- Extended thumb screws for easy focus and zoom adjustment
- Easily accessible joystick for convenient control of OSD menu system and features
- Video patch lead enables local image verification on a portable monitor
- Pan-Tilt-Twist (3-axis) gimbal enables installers to correct off-center images for properly centered images even along walls
- Conduit compatible for easy installations

Robust aluminum construction

- Vandal-resistant performance
- Withstands even the most brutal attacks
- IP66-certified for resistance to harsh outdoor elements

Certifications and Approvals

Region	Certification
Europe	CE

Installation/Configuration Notes

Dimensions

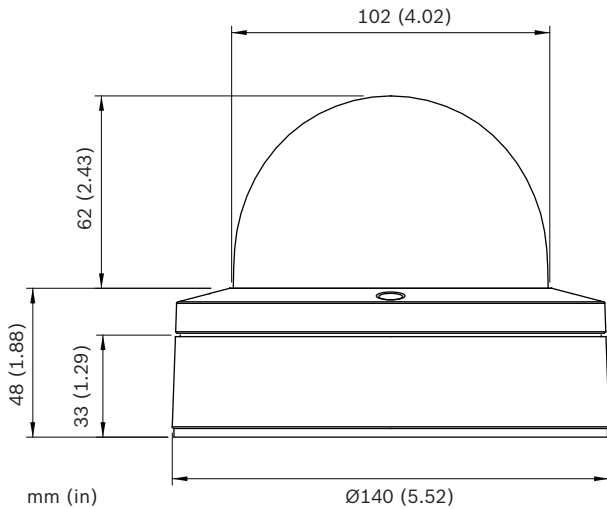

Mounting template

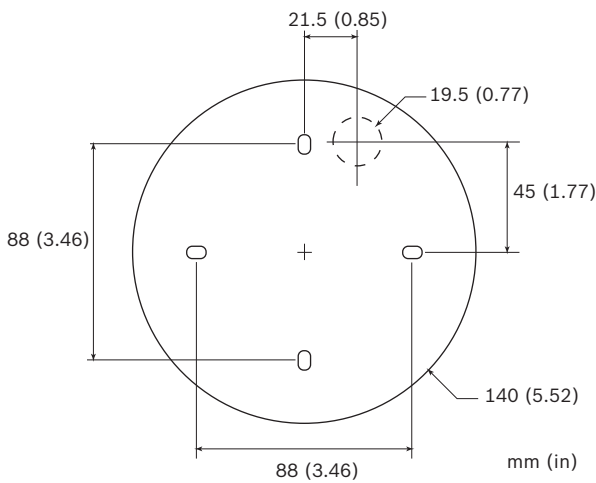

Technical Specifications

Video

CCD Camera	1/3 in CCD with Mechanical Filter Technology
Filtering	Mechanical Filter Technology
Resolution	High resolution 520 TVL
Night Time Sensitivity	0 lux (infrared on)
Day/Night Switching	Photocell-controlled, automatic
Electronics Iris	1/50 to 1/100,000 s (PAL), 1/60 to 1/100,000 s (NTSC)
Output Signal	1 VPP composite video, 75 ohm
Output connection	BNC connector
S/N Ratio	Greater than 48 dB

Gamma	0.45
Lens	3 to 12 mm varifocal auto-iris
LEDs	High efficiency 18-LED infrared array
Wavelength	850 nm

Mechanical

Housing	Surface mount dome, vandal resistant
Gimbals	3D gimbal for easy installation
Construction	Robust aluminum
Finish	Powder coat silver
Conduit Compatible	1/2-inch NPT

Electrical

Power Consumption	4.5 W max
Voltage	12 VDC or 24 VAC/DC
Power Supply	Not included

Environmental

Operational Temp.	-30 °C to +55 °C (-22 °F to 131 °F)
Environment	IP66 certified

Ordering Information

WZ45NV312-0-N Integrated Day/Night IR Dome Camera
520 TVL Integrated Day/Night IR Dome, Varifocal Auto-Iris 3 to 12 mm, 12/24 VAC/DC, NTSC
Order number **WZ45NV312-0-N**

WZ45NV312-0-P Integrated Day/Night IR Dome Camera
520 TVL Integrated Day/Night IR Dome, Varifocal Auto-Iris 3 to 12 mm, 12/24 VAC/DC, PAL
Order number **WZ45NV312-0-P**

WZ45NV312-0-NU Integrated Day/Night IR Dome Camera
520 TVL Integrated Day/Night IR Dome, Varifocal Auto-Iris 3 to 12 mm, 12/24 VAC/DC, NTSC, UTP video output
Order number **WZ45NV312-0-NU**

WZ45NV312-0-PU Integrated Day/Night Dome Camera
520 TVL Integrated Day/Night IR Dome, Varifocal Auto-Iris 3 to 12 mm, 12/24 VAC/DC, PAL, UTP video output
Order number **WZ45NV312-0-PU**

Accessories

PSU-230-24 Power Supply
Power Supply, 230 VAC / 24 VAC, 50 W
Order number **PSU-230-24**

EXPS.008 VAC Power Supply
Power supply 120 VAC/ 24 VAC 1500 mA
Order number **EXPS.008**

EX-DOM45 Replacement Dome
Replacement dome for WZ45
Order number **EX-DOM45**

Represented by:

Americas:

Bosch Security Systems, Inc.
130 Perinton Parkway
Fairport, New York, 14450, USA
Phone: +1 800 289 0096
Fax: +1 585 223 9180
security.sales@us.bosch.com
www.boschsecurity.us

Europe, Middle East, Africa:

Bosch Security Systems B.V.
P.O. Box 80002
5617 BA Eindhoven, The Netherlands
Phone: + 31 40 2577 284
Fax: +31 40 2577 330
emea.securitysystems@bosch.com
www.boschsecurity.com

Asia-Pacific:

Robert Bosch (SEA) Pte Ltd, Security
Systems
11 Bishan Street 21
Singapore 573943
Phone: +65 6571 2808
Fax: +65 6571 2699
apr.securitysystems@bosch.com
www.boschsecurity.asia

China:

Bosch (Shanghai) Security Systems Ltd.
201 Building, No. 333 Fuquan Road
North IBP
Changning District, Shanghai
200335 China
Phone +86 21 22181111
Fax: +86 21 22182398
www.boschsecurity.com.cn

America Latina:

Robert Bosch Ltda Security Systems Division
Via Anhanguera, Km 98
CEP 13065-900
Campinas, Sao Paulo, Brazil
Phone: +55 19 2103 2860
Fax: +55 19 2103 2862
al.securitysystems@bosch.com
www.boschsecurity.com